



THE DIFFERENCE IS CLEAR



# MARINE PRODUCT BROCHURE





# TABLE OF CONTENTS

<b>Who is FCI?</b> .....	<b>4 - 6</b>
<b>V4 Controls</b> .....	<b>6 - 7</b>
<b>Marine Solutions &amp; Applications</b> .....	<b>8 - 9</b>
<b>Aqualite Product Overview</b> .....	<b>10 - 11</b>
<b>Aquamiser+ Framed Product Overview</b> .....	<b>12 - 13</b>
<b>Aquamiser+ Modular Product Overview</b> .....	<b>14 - 15</b>
<b>Max-Q+ Framed Product Overview</b> .....	<b>16 - 17</b>
<b>Max-Q+ Modular Product Overview</b> .....	<b>18 - 19</b>
<b>Max-Q+ APC/DTS Double-Pass Overview</b> .....	<b>20 - 21</b>
<b>Atlas+ Framed Product Overview</b> .....	<b>22 - 23</b>
<b>Atlas+ Modular Product Overview</b> .....	<b>24 - 25</b>
<b>Atlas+ APC/DTS Double-Pass</b> .....	<b>26 - 27</b>
<b>FCI Watermakers Comparison Chart</b> .....	<b>28 - 29</b>
<b>DTS+ Product Overview</b> .....	<b>30 - 31</b>
<b>DTS+ Auto Product Overview</b> .....	<b>32 - 33</b>
<b>DTS+ Solo Product Overview</b> .....	<b>34 - 35</b>
<b>DTS+ Mobile Product Overview</b> .....	<b>36 - 37</b>
<b>DTS+ Watermakers Comparison Chart</b> .....	<b>38 - 39</b>
<b>Accessories</b> .....	<b>40</b>
<b>Distribution Locations</b> .....	<b>41</b>
<b>Contact Us</b> .....	<b>42</b>

# A COMPANY DEDICATED TO DEPENDABLE RESOURCES OF CLEAN WATER, ANYWHERE

## FCI WATERMAKERS HAVE BEEN CRUISING THE GLOBE FOR DECADES

FCI Watermakers does more than build and sell marine reverse osmosis systems. We invent the technology and advance the systems that are the future of marine desalination around the planet.



## 1 COMMERCIAL PREFILTER

Commercial quality filtration is standard with our commercial pre-filter housing and pleated 5 micron filter.

## 2 SURE-TOUCH OPERATION

Reliable tactile feedback from FCI's watermaker control panel eliminates operator error and provides automatic programming with at-a-glance monitoring. The tried and true technology and digital displays are resilient to all boating conditions, unlike touchscreens that potentially fail in high-temperature climates or engine rooms. The FCI V4 Controller Technology leads the market with complete automation and Marine certifications.

## 3 NOISE CONTROL

Engineering the industry's only frame with eight-point vibration isolation, our watermaking systems are quiet due to its open frame construction, eight-point isolating mounts and low RPM high-pressure pump. Competing systems amplify noise due to closed-frame construction and high-pressure pumps running at double the RPMs which creates a systemic, throbbing resonance throughout the vessel.

## 4 LOW PRESSURE PUMP

Designed to withstand wet marine environments, FCI's washdown duty motor is epoxy coated with neoprene gaskets and 316 stainless steel shafts that protect it from moisture, rot and rust. FCI motors will outlast competing brands, which use inferior general or industrial duty motors with lesser features, like painted housing, paper gaskets and standard steel shafts.

## 5 SUPERIOR MATERIALS

Industrial-quality materials ensure the durability and longevity of every FCI watermaker. Our systems are engineered with durable parts made from quality metals like 316L stainless steel, instead of plastic which provides strength and reliable operation by preventing corrosion as well as undo wear and tear.

## 6 PRESSURE VESSELS

FCI is so confident of the superiority of our engineering that we offer a lifetime warranty on every pressure vessel tube and have never yet had a claim. Four 316L stainless steel rods surround the vessel, while ports are specifically designed to flex and move with the pressure to remove stress. FCI's watermakers feature a superior end plug design that prevents loosening, leaks, cracking and salt water crystallization due to natural vibration and water pressure.

## 7 MEMBRANES

While all of our marine systems designs are engineered to be compatible with standard size membranes, allowing for readiness and ease of use for our customers no matter where they are, we manufacture and ship our membranes composed of the same high-quality materials and fabrication our products are known for. These membranes are best matched with our watermaker's engineering performance specifications and provide the highest water quality and increase membrane performance.

## 8 FRESH WATER FLUSH INCLUDED

Fresh water flush is an included feature in FCI marine systems from 250 gallons per day (GPD) to 3,000 gallons per day (GPD). While most competing brands consider this function an accessory and extra charge, FCI believes in providing a comprehensive system that offers optimal performance. What's more, with our V4 Control System, your fresh water flush is automatic and fully programmable—you control the frequency and duration to suit your needs under divergent water conditions and usage.

## 9 HIGH / LOW PRESSURE TRANSDUCER

FCI's 316L stainless steel transducers offer users multiple function settings and continuous digital readouts. The user can customize the system to meet specific needs and effectively monitor the operation of the system during use. Many other brands use switches instead of transducers, which limit a user's regulation to "on" and "off" functions only.



# COMMITTED TO THE PURSUIT OF INNOVATION IN REVERSE OSMOSIS TECHNOLOGY

## OUR WATERMAKER SOLUTIONS PROVIDE THE HIGHEST QUALITY AND RELIABILITY, GUARANTEED.

For more than 30 years, FCI Watermakers has been a leader in the reverse osmosis watermaker industry due to our engineers' endless pursuit and drive for innovation, improved performance and the reliability needed when producing clean water.

FCI's team of engineers first pioneered the integration of the UROC (Universal Reverse Osmosis Controller), which allowed features and automation never before seen in a marine watermaker. Now, having further developed this automation technology, FCI has introduced our V4 Controls, which not only offer the industry standard automation of one-touch commands and remote system control but also feature detailed system performance, stage of operation production rates, operation PSI and more.



### HOME

Simple one-touch operation. Start or Stop the system, or perform a water flush.



### SETUP

FCI V4 controls let you be in command. Whether it's adjusting run time, gallons produced or simply setting up the standard Fresh Water Flush time, the V4 control is very intuitive and easy to use.



### START

Monitor system data, including PSI, flow rates and system temperature. View your system's status anytime.

# V4 CONTROLS

# AVAILABLE IN 7" OR 4.3"



## OVERVIEW

Provides a snapshot of your system's performance and stage of operation, including production rates and operational PSI.



## APC CONTROL

With our APC (Automated Pressure Control) your system becomes fully automated. Run off of tank level controls, time of day, or simply touch the start icon and walk away.



## SIZES

Available in two different sizes, 7" or 4.3"

# MARINE SOLUTIONS & APPLICATIONS

As both engineers and craftsmen, we specialize in dependable, high-performance and value-driven marine watermakers, and are proud of the thousands of continuously operating RO units that have been cruising the globe for decades.

Explore our marine solutions offering water from 200 gpd (gallons per day) to 3,600 gpd.



## SPORTFISHING VESSEL

200 - 1,200 GPD



## MIDSIZE YACHT

600 - 1,850 GPD



## SUPERYACHT

1,400 - 3,600 GPD

OUR CONTROLLER TECHNOLOGY AND REVERSE OSMOSIS DESALINATORS MEET OR EXCEED CURRENT REGULATIONS FROM THE FOLLOWING AGENCIES:







# AQUALITE

## PRODUCT OVERVIEW



### HIGHLIGHTS

**A full-featured and affordable solution.**

- Exclusive AQ3 full featured control system
- Low power draw to enable inverter use
- Small footprint for installation in small spaces



### SPECIFICATIONS

**AVAILABLE OUTPUT**

**GPD 200**

**ELECTRICAL REQUIREMENTS**

**HP 0.75**

**KW 0.61**

**VAC 120 / 208-240**

**Phase 1**

**HZ 50 / 60**

# AQUALITE

## PARTS & DIMENSIONS

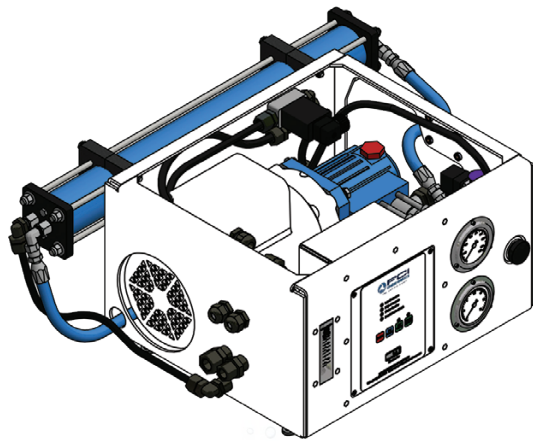

### UNIT WIDTH

Frame Only	20.15 in / 511.81 mm
With Membrane	28.00 in / 711.20 mm

### UNIT DEPTH

Frame Only	16.10 in / 408.94 mm
With Membrane	20.10 in / 510.94 mm

### UNIT HEIGHT

Frame Only	11.00 in / 279.40 mm
------------	----------------------

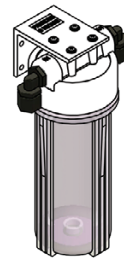

### PRE-FILTER

Width	7.50 in / 190.50 mm
Depth	5.20 in / 132.08 mm
Height	12.45 in / 316.23 mm

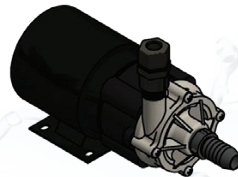

### LP PUMP

Width	3.90 in / 99.06 mm
Depth	10.15 in / 257.81 mm
Height	6.55 in / 166.37 mm

### AVAILABLE PRODUCT OPTIONS

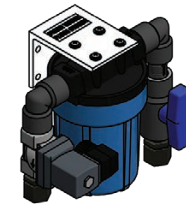

### FRESH WATER FLUSH

Width	9.16 in / 232.66 mm
Depth	6.12 in / 155.45 mm
Height	8.28 in / 210.31 mm



### AQ3 REMOTE

Width	5.42 in / 137.67 mm
Depth	2.12 in / 53.85 mm
Height	4.11 in / 104.39 mm

# AQUAMISER+ FRAMED

## PRODUCT OVERVIEW



## HIGHLIGHTS

### A full-featured and affordable solution.

- Traditional Watermaker providing Analog pressure and flow readings
- Exclusive AQ3 Control System with staged starting of motors
- Fully automated programmable Fresh Water Flush system



## SPECIFICATIONS

### AVAILABLE OUTPUT

**GPD 250 / 500 / 600 / 800 / 1,200 / 1,800**

### ELECTRICAL REQUIREMENTS

**HP 1.5 (250-800) / 2.5 (1200-1800)**

**KW 1.52 (250-800) / 2.29 (1200-1800)**

**VAC 120 / 208-240 / 380 / 480**

**Phase 1 / 3**

**HZ 50 / 60**



# AQUAMISER+ FRAMED

## PARTS & DIMENSIONS

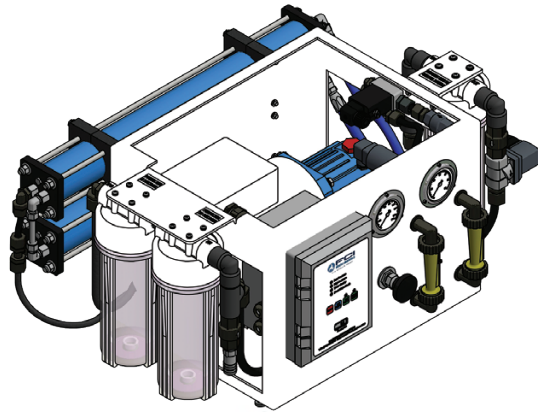

### UNIT WIDTH

Frame Only	24.75 in / 628.65 mm
250-500 GPD Units	31.50 in / 800.10 mm
600-1800 GPD Units	47.00 in / 1193.80 mm

### UNIT DEPTH

Frame Only	17.05 in / 433.07 mm
With Membranes	20.90 in / 530.86 mm

### UNIT HEIGHT

Frame Only	14.75 in / 374.65 mm
------------	----------------------

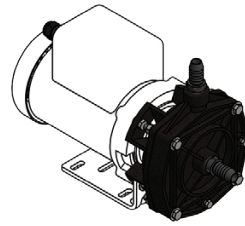

### LP PUMP

Width	7.30 in / 185.42 mm
Depth	15.95 in / 405.13 mm
Height	10.75 in / 273.05 mm

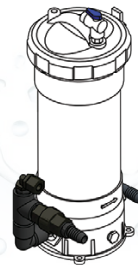

### COMMERCIAL PRE-FILTER 1200-1800

Width	11.10 in / 281.94 mm
Depth	9.60 in / 243.83 mm
Height	20.50 in / 520.70 mm

### AVAILABLE PRODUCT OPTIONS

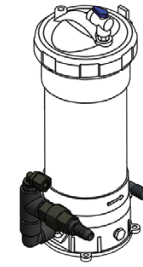

### COMMERCIAL PRE-FILTER 250-800

Width	11.10 in / 281.94 mm
Depth	9.60 in / 243.83 mm
Height	20.50 in / 520.70 mm



### AQ3 REMOTE

Width	5.42 in / 137.67 mm
Depth	2.12 in / 53.85 mm
Height	4.11 in / 104.39 mm

# AQUAMISER+ MODULAR

## PRODUCT OVERVIEW



## HIGHLIGHTS

**A full-featured and affordable solution for tight spaces and bulkheads.**

- Traditional Watermaker providing Analog pressure and flow readings
- Exclusive AQ3 Control System with staged starting of motors
- Fully automated programmable Fresh Water Flush system



## SPECIFICATIONS

### AVAILABLE OUTPUT

**GPD 250 / 500 / 600 / 800 / 1,200 / 1,800**

### ELECTRICAL REQUIREMENTS

**HP 1.5 (250-800) / 2.5 (1200-1800)**

**KW 1.52 (250-800) / 2.29 (1200-1800)**

**VAC 120 / 208-240 / 380 / 480**

**Phase 1 / 3**

**HZ 50 / 60**

# AQUAMISER+ MODULAR

## PARTS & DIMENSIONS

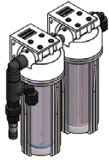

### PRE-FILTER 250-800

Width	13.45 in / 341.63 mm
Depth	5.20 in / 132.08 mm
Height	12.45 in / 316.23 mm



### CONTROL PANEL

Width	7.65 in / 194.31 mm
Depth	6.30 in / 160.02 mm
Height	9.40 in / 238.76 mm



### FRESH WATER FLUSH

Width	9.30 in / 236.22 mm
Depth	6.10 in / 154.94 mm
Height	12.45 in / 316.23 mm



### COMMERCIAL PRE-FILTER 1200-1800

Width	11.10 in / 281.94 mm
Depth	9.60 in / 243.83 mm
Height	20.50 in / 520.70 mm

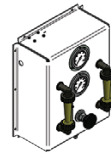

### FLOW PANEL

Width	11.50 in / 292.10 mm
Depth	7.20 in / 182.88 mm
Height	15.15 in / 384.81 mm



### PRESSURE VESSEL 250-500

Width	27.75 in / 704.85 mm
Depth	4.00 in / 101.60 mm
Height	4.00 in / 101.60 mm (1 Vessel) 8.25 in / 209.55 mm (2 Vessel)

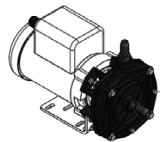

### LP PUMP

Width	7.30 in / 185.42 mm
Depth	15.95 in / 405.13 mm
Height	10.75 in / 273.05 mm

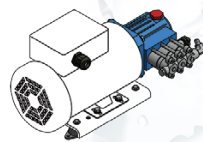

### HP PUMP

Width	20.95 in / 532.13 mm
Depth	9.65 in / 245.11 mm
Height	10.65 in / 270.51 mm

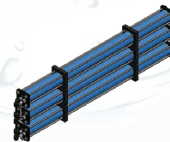

### PRESSURE VESSEL 600-1800

Width	47.00 in / 1193.80 mm
Depth	4.00 in / 101.60 mm
Height	4.00 in / 101.60 mm (1 Vessel) 8.25 in / 209.55 mm (2 Vessel) 12.50 in / 317.50 mm (3 Vessel)

## AVAILABLE PRODUCT OPTIONS

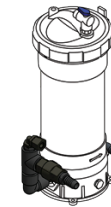

### COMMERCIAL PRE-FILTER 250-800

Width	11.10 in / 281.94 mm
Depth	9.60 in / 243.83 mm
Height	20.50 in / 520.70 mm



### AQ3 REMOTE

Width	5.42 in / 137.67 mm
Depth	2.12 in / 53.85 mm
Height	4.11 in / 104.39 mm

# MAX-Q+ FRAMED

## PRODUCT OVERVIEW



## HIGHLIGHTS

The most dependable and advanced water purifying system for boaters.

- The industry's only Marine Certified HMI/PLC Touch Screen V4 Control System
- Exclusive NEMA 4X rated enclosures and valves for safety and protection in harsh environment
- 8-point Vibration Isolation for exceptionally quiet operation



## SPECIFICATIONS

AVAILABLE OUTPUT

**GPD 700 / 1,275 / 1,850**

ELECTRICAL REQUIREMENTS

**HP 2.5**

**KW 2.29**

**VAC 120 / 208-240 / 380 / 480**

**Phase 1 / 3**

**HZ 50 / 60**



# MAX-Q+ FRAMED

## PARTS & DIMENSIONS

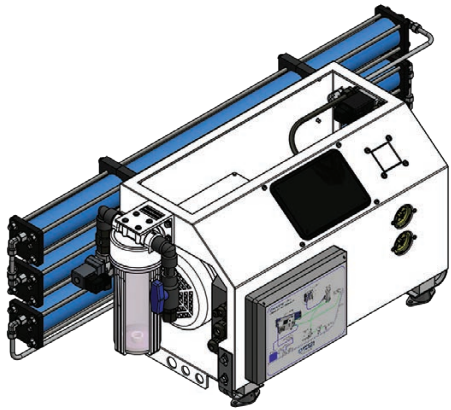

### UNIT WIDTH

Frame Only	25.00 in / 635.00 mm
With FWF Filter	31.00 in / 787.40 mm
With Membranes	47.15 in / 1197.61 mm

### UNIT DEPTH

Frame Only	15.30 in / 388.62 mm
With Membranes	19.55 in / 496.57 mm

### UNIT HEIGHT

Frame Only	17.00 in / 431.80 mm
------------	----------------------

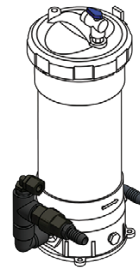

### PRE-FILTER

Width	11.10 in / 281.94 mm
Depth	9.60 in / 243.83 mm
Height	20.50 in / 520.70 mm

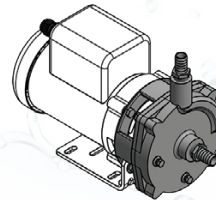

### LP PUMP

Width	7.15 in / 181.61 mm
Depth	15.90 in / 403.86 mm
Height	10.80 in / 274.32 mm

### AVAILABLE PRODUCT OPTIONS



### V4 REMOTE 4.3"

Width	5.71 in / 145.03 mm
Depth	2.13 in / 54.10 mm
Height	4.09 in / 103.89 mm

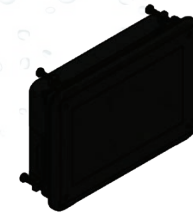

### V4 REMOTE 7"

Width	8.04 in / 204.22 mm
Depth	2.13 in / 54.10 mm
Height	5.64 in / 143.26 mm

# MAX-Q+ MODULAR

## PRODUCT OVERVIEW



## HIGHLIGHTS

The industry's most reliable, and technologically advanced Watermaker for limited installation spaces.

- Separate components installed to fit your installation space
- The industry's only Marine Certified HMI/PLC Touch Screen V4 Control System
- Exclusive NEMA 4X rated enclosures and valves for safety and protection in harsh environments



## SPECIFICATIONS

### AVAILABLE OUTPUT

**GPD 700 / 1,275 / 1,850**

### ELECTRICAL REQUIREMENTS

**HP 2.5**

**KW 2.29**

**VAC 120 / 208-240 / 380 / 480**

**Phase 1 / 3**

**HZ 50 / 60**

# MAX-Q+ MODULAR

## PARTS & DIMENSIONS



### PRE-FILTER

Width	11.10 in / 281.94 mm
Depth	9.60 in / 243.83 mm
Height	20.50 in / 520.70 mm

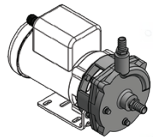

### LP PUMP

Width	7.15 in / 181.61 mm
Depth	15.90 in / 402.86 mm
Height	10.80 in / 274.32 mm

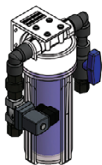

### FRESH WATER FLUSH

Width	9.30 in / 236.22 mm
Depth	6.10 in / 154.94 mm
Height	12.45 in / 316.23 mm

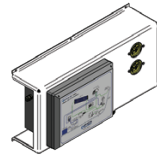

### FLOW PANEL

Width	21.50 in / 546.10 mm
Depth	7.00 in / 177.80 mm
Height	12.10 in / 307.34 mm

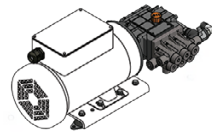

### HP PUMP

Width	24.50 in / 622.30 mm
Depth	9.65 in / 245.11 mm
Height	10.65 in / 270.51 mm

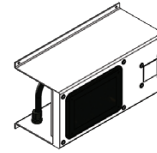

### CONTROL PANEL

Width	15.00 in / 127.00 mm
Depth	6.80 in / 172.72 mm (APC Control) 8.45 in / 214.63 mm (Manual Control)
Height	8.70 in / 220.98 mm



### PRESSURE VESSEL

Width	47.00 in / 1193.80 mm
Depth	4.00 in / 101.60 mm
Height	4.00 in / 101.60 mm (1 Vessel) 8.25 in / 209.55 mm (2 Vessel) 12.50 in / 317.50 mm (3 Vessel)

### AVAILABLE PRODUCT OPTIONS



### V4 REMOTE 4.3"

Width	5.71 in / 145.03 mm
Depth	2.13 in / 54.10 mm
Height	4.09 in / 103.89 mm

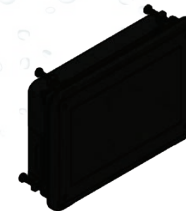

### V4 REMOTE 7"

Width	8.04 in / 204.22 mm
Depth	2.13 in / 54.10 mm
Height	5.64 in / 143.26 mm

# MAX-Q+APC/DTS DOUBLE-PASS

## PRODUCT OVERVIEW



## HIGHLIGHTS

The Flagship of our Max-Q Series, containing 3 systems in 1 compact frame.

- Max-Q+APC and DTS+ in one all-inclusive system
- The only true, one-touch fully automatic combo unit on the market
- The industry's only Marine Certified HMI/PLC Touch Screen V4 Control System



## SPECIFICATIONS

### AVAILABLE OUTPUT

**SEAWATER** 1,275 / 1,850 GPD

**DOUBLE-PASS** 900 / 1,200 GPD

**DOCKSIDE** 2,000 GPD

### ELECTRICAL REQUIREMENTS

**HP** 2.5

**KW** 2.29

**VAC** 120 / 208-240 / 380 / 480

**Phase** 1 / 3

**HZ** 50 / 60



# MAX-Q+APC/DTS DOUBLE-PASS

## PARTS & DIMENSIONS

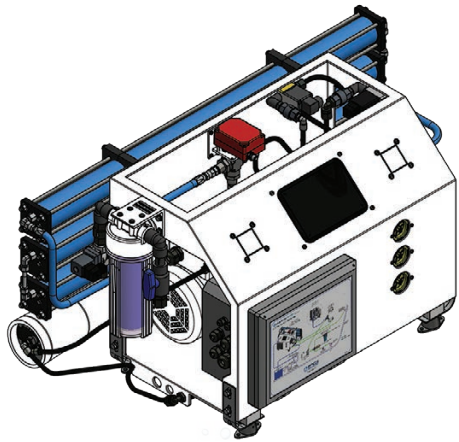

### UNIT WIDTH

Frame Only	31.55 in / 801.37 mm
With FWF Filter	36.40 in / 924.56 mm
With Membranes	47.00 in / 1193.80 mm

### UNIT DEPTH

Frame Only	18.35 in / 466.09 mm
With Membranes	23.25 in / 590.55 mm

### UNIT HEIGHT

Frame Only	21.60 in / 548.64 mm
------------	----------------------

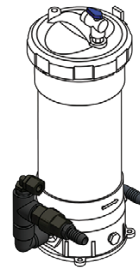

### PRE-FILTER

Width	11.10 in / 281.94 mm
Depth	9.60 in / 243.83 mm
Height	20.50 in / 520.70 mm

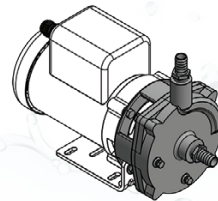

### LP PUMP

Width	7.15 in / 181.61 mm
Depth	15.90 in / 403.86 mm
Height	10.80 in / 274.32 mm

### AVAILABLE PRODUCT OPTIONS

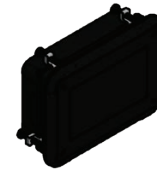

### V4 REMOTE 4.3"

Width	5.71 in / 145.03 mm
Depth	2.13 in / 54.10 mm
Height	4.09 in / 103.89 mm

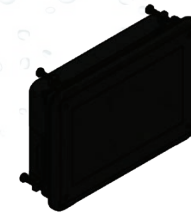

### V4 REMOTE 7"

Width	8.04 in / 204.22 mm
Depth	2.13 in / 54.10 mm
Height	5.64 in / 143.26 mm

# ATLAS+ FRAMED

## PRODUCT OVERVIEW



## HIGHLIGHTS

**Bridging the gap between small and mighty.**

- Compact, High-output Commercial System
- Exclusive Marine Certified HMI/PLC Touch Screen V4 Control System
- 8-point Vibration Isolation Mounts for quiet operation



## SPECIFICATIONS

### AVAILABLE OUTPUT

**GPD 1,400 / 2,000 / 2,500 / 2,800 / 3,600**

### ELECTRICAL REQUIREMENTS

**HP 5**

**KW 4.47**

**VAC 208-240 / 380 / 480**

**Phase 1 / 3**

**HZ 50 / 60**

# ATLAS+ FRAMED

## PARTS & DIMENSIONS

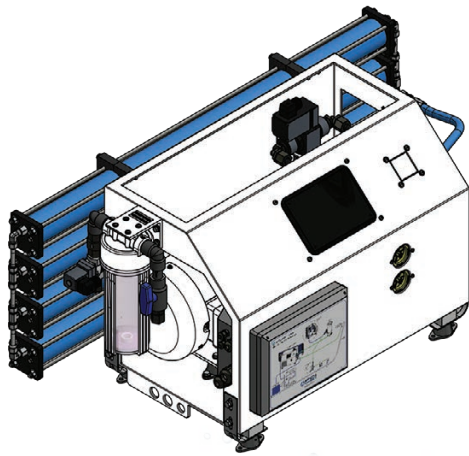

### UNIT WIDTH

Frame Only	31.10 in / 789.94 mm
With FWF Filter	37.10 in / 942.34 mm
With Membranes (1400-2500 GPD)	47.00 in / 1193.80 mm
With Membranes (2800 GPD)	54.70 in / 1389.38 mm

### UNIT DEPTH

Frame Only	18.30 in / 464.82 mm
With Membranes (1400-2500 GPD)	22.30 in / 566.42 mm
With Membranes (2800 GPD)	24.30 in / 617.22 mm

### UNIT HEIGHT

Frame Only	20.60 in / 523.24 mm
------------	----------------------



### PRE-FILTER

Width	11.10 in / 281.94 mm
Depth	9.60 in / 243.83 mm
Height	20.50 in / 520.70 mm

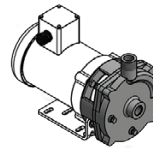

### LP PUMP

Width	6.90 in / 175.26 mm
Depth	13.50 in / 432.90 mm
Height	9.15 in / 232.41 mm

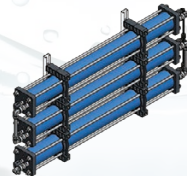

### PRESSURE VESSEL 3600 GPD

Width	54.70 in / 1389.38 mm
Depth	6.80 in / 172.72 mm
Height	27.20 in / 690.88 mm

### AVAILABLE PRODUCT OPTIONS

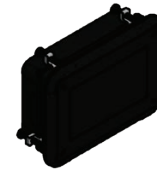

### V4 REMOTE 4.3"

Width	5.71 in / 145.03 mm
Depth	2.13 in / 54.10 mm
Height	4.09 in / 103.89 mm

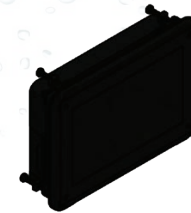

### V4 REMOTE 7"

Width	8.04 in / 204.22 mm
Depth	2.13 in / 54.10 mm
Height	5.64 in / 143.26 mm

# ATLAS+ MODULAR

## PRODUCT OVERVIEW



## HIGHLIGHTS

**Bridging the gap between small and mighty in tight spaces.**

- Compact, High-output Commercial System
- Exclusive Marine Certified HMI/PLC Touch Screen V4 Control System
- 8-point Vibration Isolation Mounts for quiet operation



## SPECIFICATIONS

### AVAILABLE OUTPUT

**GPD 1,400 / 2,000 / 2,500 / 2,800 / 3,600**

### ELECTRICAL REQUIREMENTS

**HP 5**

**KW 4.47**

**VAC 208-240 / 380 / 480**

**Phase 1 / 3**

**HZ 50 / 60**

# ATLAS+ MODULAR

## PARTS & DIMENSIONS



### PRE-FILTER

Width	11.10 in / 281.94 mm
Depth	9.60 in / 243.83 mm
Height	20.50 in / 520.70 mm



### FRESH WATER FLUSH

Width	9.30 in / 236.22 mm
Depth	6.10 in / 154.94 mm
Height	12.45 in / 316.23 mm

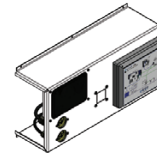

### CONTROL / FLOW PANEL

Width	26.00 in / 660.40 mm
Depth	9.30 in / 236.22 mm
Height	14.45 in / 367.03 mm

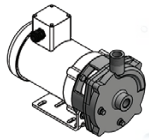

### LP PUMP

Width	6.90 in / 175.26 mm
Depth	13.50 in / 432.90 mm
Height	9.15 in / 232.41 mm

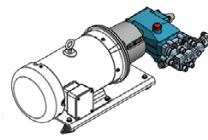

### HP PUMP

Width	30.45 in / 773.43 mm
Depth	13.90 in / 353.06 mm
Height	10.45 in / 265.43 mm



### PRESSURE VESSEL 1400-2500 GPD

Width	47.00 in / 1193.80 mm
Depth	4.00 in / 101.60 mm
Height	8.25 in / 209.55 mm (2 Vessel) 12.50 in / 317.50 mm (3 Vessel) 16.75 in / 425.45 mm (4 Vessel)

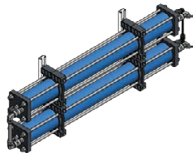

### PRESSURE VESSEL 2800 GPD

Width	54.70 in / 1389.38 mm
Depth	6.80 in / 172.72 mm
Height	19.30 in / 490.22 mm



### PRESSURE VESSEL 3600 GPD

Width	54.70 in / 1389.38 mm
Depth	6.80 in / 172.72 mm
Height	27.20 in / 690.88 mm

### AVAILABLE PRODUCT OPTIONS

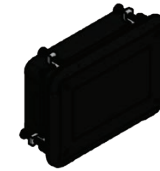

### V4 REMOTE 4.3"

Width	5.71 in / 145.03 mm
Depth	2.13 in / 54.10 mm
Height	4.09 in / 103.89 mm

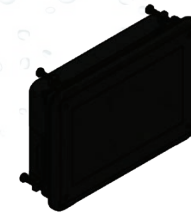

### V4 REMOTE 7"

Width	8.04 in / 204.22 mm
Depth	2.13 in / 54.10 mm
Height	5.64 in / 143.26 mm



# ATLAS+APC/DTS DOUBLE-PASS

## PRODUCT OVERVIEW



## HIGHLIGHTS

**Bridging the gap between small and mighty.**

- Atlas+APC and DTS+ in one all-inclusive commercial system
- The only true, one-touch fully automatic combo unit on the market
- The industry's only Marine Certified HMI/PLC Touch Screen V4 Control System



## SPECIFICATIONS

### AVAILABLE OUTPUT

**SEAWATER 2,000 / 2,500 / 2,800 / 3,600 GPD**

**DOUBLE-PASS 1,400 / 1,750 / 2,000 / 2,500 GPD**

**DOCKSIDE 3,000 GPD**

### ELECTRICAL REQUIREMENTS

**HP 5**

**KW 4.47**

**VAC 208-240 / 380 / 480**

**Phase 1 / 3**

**HZ 50 / 60**

# ATLAS+APC/DTS DOUBLE-PASS

## PARTS & DIMENSIONS

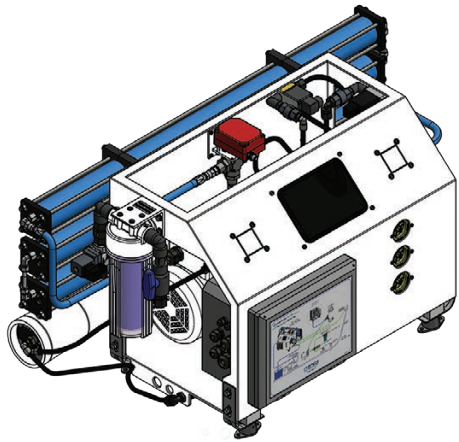

### UNIT WIDTH

Frame Only	31.55 in / 801.37 mm
With FWF Filter	36.40 in / 924.56 mm
With Membranes	47.00 in / 1193.80 mm

### UNIT DEPTH

Frame Only	18.35 in / 466.09 mm
With Membranes	23.25 in / 590.55 mm

### UNIT HEIGHT

Frame Only	21.60 in / 548.64 mm
------------	----------------------

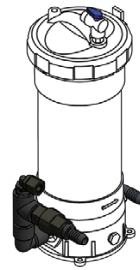

### PRE-FILTER

Width	11.10 in / 281.94 mm
Depth	9.60 in / 243.83 mm
Height	20.50 in / 520.70 mm

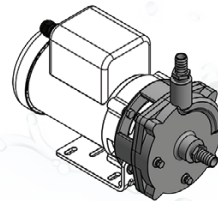

### LP PUMP

Width	7.15 in / 181.61 mm
Depth	15.90 in / 403.86 mm
Height	10.80 in / 274.32 mm

### AVAILABLE PRODUCT OPTIONS



### V4 REMOTE 4.3"

Width	5.71 in / 145.03 mm
Depth	2.13 in / 54.10 mm
Height	4.09 in / 103.89 mm

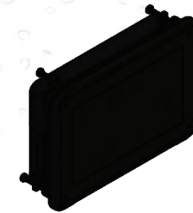

### V4 REMOTE 7"

Width	8.04 in / 204.22 mm
Depth	2.13 in / 54.10 mm
Height	5.64 in / 143.26 mm

# COMPARE FCI WATERMAKERS



**AQUALITE**



**AQUAMISER+**



**MAX-Q+APC**



**MAX-Q+APC/DP**

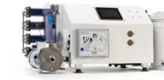

**ATLAS+APC**



**ATLAS+APC/DP**

**SERIES**

**OUTPUT**

GPD	200	250-1800	700-1850	SP (Single Pass): 1275-1850 DP (Double Pass): 900-1200 DTS (Dockside): 2000	1400-3600	SP (Single Pass): 2000-3600 DP (Double Pass): 1400-2500 DTS (Dockside): 2000
-----	-----	----------	----------	---	-----------	--

**FEATURES**

Available in Modular Configuration		☺	☺		☺	
Washdown Duty Feed Pump Motor		☺	☺	☺	☺	☺
316SS Feed Pump Shaft		☺	☺	☺	☺	☺
40 sq. ft. Commercial Pre-filter		NC Upgrade	☺	☺	☺	☺
Washdown Duty Main Driver Motor		☺	☺	☺	☺	☺
4-point Vibration Isolation	☺					
Dual-mount with 8-point Vibration Isolation		☺	☺	☺	☺	☺
316SS Pressure Vessel Ports	☺	☺	☺	☺	☺	☺
Upgradable		☺	☺	☺	☺	☺
Exclusive AQ3 Control System	☺	☺				
Exclusive V4 Control System			☺	☺	☺	☺
Automatic Pressure Control (APC)			☺	☺	☺	☺
7" Marine Certified Touch Screen			☺	☺	☺	☺
Analog Flow Meters	☺	☺				
Digital Flow Meters			☺	☺	☺	☺
Analog Guages	☺	☺				
Digital Pressure Readout			☺	☺	☺	☺
Programmable Automatic Fresh Water Flush	Optional	☺	☺	☺	☺	☺
NMEA Compatible			☺	☺	☺	☺
MODBUS Ready			☺	☺	☺	☺
On-Screen Help Menu			☺	☺	☺	☺
Dual Hertz Capable	☺	☺	☺	☺	☺	☺
TDS Readout	w/ Remote	w/ Remote	☺	☺	☺	☺
Touch Pad Controls	☺	☺				
Low Power Consumption	☺					
Double Pass Spot-Free Water				☺		☺
Integrated DTS System				☺		☺
3:1 Operational Modes				☺		☺

# COMPARE FCI WATERMAKERS



**AQUALITE**



**AQUAMISER+**



**MAX-Q+APC**



**MAX-Q+APC/DP**

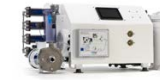

**ATLAS+APC**



**ATLAS+APC/DP**

**SERIES**

OPTIONS						
DTS Compatible		↻	↻		↻	
Remote Stations	↻	↻	↻	↻	↻	↻
Bridge Certified HMI Remote Station			↻	↻	↻	↻
pH Neutralizer	↻	↻	↻	↻	↻	↻
Automated or Manual Media Filters		↻	↻	↻	↻	↻
UV Sterilizer	↻	↻	↻	↻	↻	↻
DTS Feed Water Pressure Regulator				↻		↻
Filter Replacement Kit	↻	↻	↻	↻	↻	↻

DIMENSIONS						
Width without Membrane	20.15 in / 511.81 mm	24.75 in / 628.65 mm	31.30 in / 789.94 mm	31.55 in / 801.37 mm	31.30 in / 789.94 mm	25.00 in / 635.00 mm
Depth without Membrane	16.10 in / 408.94 mm	17.05 in / 433.07 mm	18.30 in / 464.82 mm	18.35 in / 466.09 mm	18.30 in / 464.82 mm	15.30 in / 388.62 mm
Height	11.00 in / 279.40 mm	14.75 in / 374.65 mm	20.60 in / 523.24 mm	21.60 in / 548.64 mm	20.60 in / 523.24 mm	17.00 in / 431.80 mm
Width with Membrane	28.00 in / 711.20 mm	31.50-47.00 in / 800.10-1193.80 mm†	47.00 -54.70 in / 1193.80-1389.38 mm†	47.00 in / 1193.80 mm	47.00 -54.70 in / 1193.80-1389.38 mm†	47.15 in / 1197.61 mm
Depth with Membrane	20.10 in / 510.94 mm	20.90 in / 530.86 mm	22.30 -24.30 in / 566.42-617.22 mm†	23.25 in / 590.55 mm	22.30 -24.30 in / 566.42-617.22 mm†	19.55 in / 496.57 mm

† Depending on output / model

**ALL FCI WATERMAKERS SYSTEMS INCLUDE:**

- Worldwide Support
- Non-proprietary Membranes
- Feed Pump
- 316SS HP Pump
- 316SS HP Fittings
- 5 micron Pre-filtration
- Multiple Remote Station Capable
- Stage Starting
- TDS Monitoring
- Automatically Diverts good water to the tanks
- Over Pressure Protection
- Loss of Prime Protection
- Tank Level Control
- NEMA 4X Electrical Enclosure
- Compact Small Footprint
- One-piece Aluminum Powder Coated Frame Construction

# DTS+

## PRODUCT OVERVIEW



## HIGHLIGHTS

### In-line spot-free dockside treatment system.

- Provides spot-free water from your municipal or dockside source
- Utilizes your existing pump and control system
- Up to 70% recovery rate for increased production and less waste
- Included GAC filter helps prolong membrane life

## SPECIFICATIONS

### AVAILABLE OUTPUT

**GPD 600 / 700 / 1200 / 1275 / 1800 / 1850**



# DTS+

## PARTS & DIMENSIONS

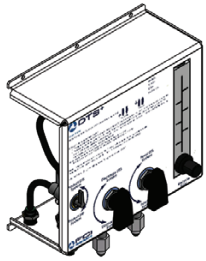

### CONTROL PANEL

Width	12.00 in / 304.80 mm
Depth	6.32 in / 160.53 mm
Height	12.84 in / 326.14 mm

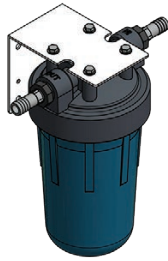

### GAC FILTER

Width	12.31 in / 312.67 mm
Depth	8.09 in / 205.49 mm
Height	13.76 in / 349.50 mm

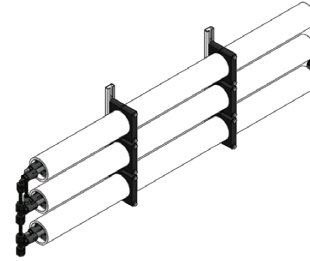

### PRESSURE VESSELS

Width	47.40 in / 1203.96 mm
Depth	4.39 in / 111.51 mm
Height	7.00 in / 177.80 mm (1 Vessel) 11.45 in / 290.83 mm (2 Vessel) 16.00 in / 406.40 mm (3 Vessel)

# DTS+ AUTO

## PRODUCT OVERVIEW



## HIGHLIGHTS

### Automatic in-line spot-free dockside treatment system.

- Provides spot-free water from your municipal or dockside source
- Fully automated and operable using your existing Watermaker controls, pump and motor
- Up to 70% recovery rate for increased production and less waste
- Included GAC filter helps prolong membrane life
- Exclusive NEMA 4X rated electrical enclosure for safety and protection in harsh environments

## SPECIFICATIONS

### AVAILABLE OUTPUT

**GPD 700 / 1275 / 1850**

### ELECTRICAL REQUIREMENTS

**VAC 120 / 208-240**

**Phase 1**

**HZ 50 / 60**

# DTS+ AUTO

## PARTS & DIMENSIONS

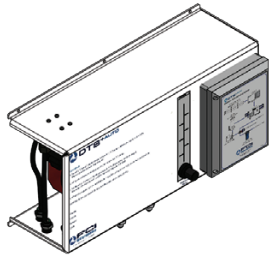

### CONTROL PANEL

Width	22.00 in / 558.80 mm
Depth	8.58 in / 217.93 mm
Height	12.72 in / 323.09 mm

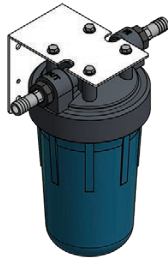

### GAC FILTER

Width	12.31 in / 312.67 mm
Depth	8.09 in / 205.49 mm
Height	13.76 in / 349.50 mm

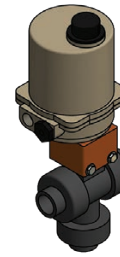

### FEED VALVE

Width	5.23 in / 132.84 mm
Depth	4.45 in / 113.03 mm
Height	13.66 in / 346.96 mm

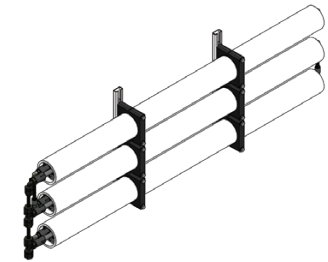

### PRESSURE VESSELS

Width	47.40 in / 1203.96 mm
Depth	4.39 in / 111.51 mm
Height	7.00 in / 177.80 mm (1 Vessel) 11.45 in / 290.83 mm (2 Vessel) 16.00 in / 406.40 mm (3 Vessel)

# DTS+ SOLO

## PRODUCT OVERVIEW



### HIGHLIGHTS

---

Available as single-pass or double-pass via any watermaker water feed.

- Purify dock water for drinking and cooking with no equipment on the dock needed
- Spot-free wash-down saves time, with no need to chamois-dry surfaces
- Recovers up to 80% of processed water



### SPECIFICATIONS

---

AVAILABLE OUTPUT

**GPD 2,000 / 3,000**

ELECTRICAL REQUIREMENTS

**HP 0.75**

**KW 0.56**

**VAC 120 / 208-240**

**Phase 1**

**HZ 50 / 60**

# DTS+ SOLO

## PARTS & DIMENSIONS

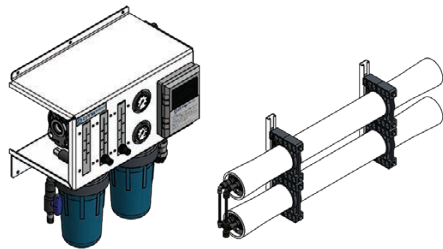

### WALL MOUNT (INCLUDES PRESSURE VESSELS)

Width	23.42 in / 594.87 mm
Depth	13.96 in / 354.58 mm
Height	26.59 in / 675.39 mm

### MODULAR MOUNT COMPONENTS

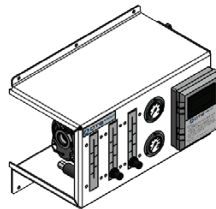

### MODULAR CONTROL PANEL

Width	23.42 in / 594.87 mm
Depth	13.96 in / 354.58 mm
Height	16.93 in / 430.02 mm

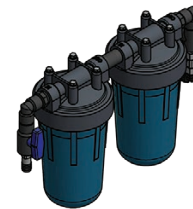

### MODULAR GAC / PRE-FILTER

Width	22.24 in / 564.90 mm
Depth	7.13 in / 181.10 mm
Height	13.93 in / 353.82 mm

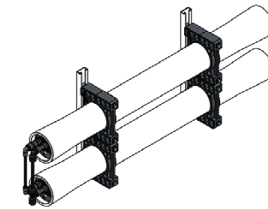

### PRESSURE VESSELS

Width	48.69 in / 1236.73 mm
Depth	7.11 in / 180.59 mm
Height	11.50 in / 292.10 mm (1 Vessel) 19.30 in / 490.22 mm (2 Vessels)

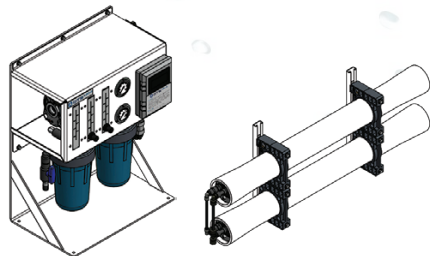

### DECK MOUNT (INCLUDES PRESSURE VESSELS)

Width	23.42 in / 594.87 mm
Depth	14.44 in / 366.78 mm
Height	30.00 in / 762.00 mm

### AVAILABLE PRODUCT OPTIONS

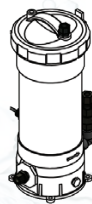

### DOUBLE PASS HOUSING

Width	10.25 in / 260.35 mm
Depth	7.97 in / 202.44 mm
Height	19.12 in / 485.65 mm



### DOUBLE PASS HOUSING W/ V4 INTEGRATION

Width	12.92 in / 328.17 mm
Depth	7.97 in / 202.44 mm
Height	19.12 in / 485.65 mm

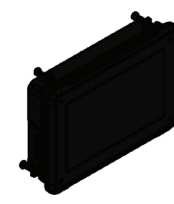

### DTS+ SOLO REMOTE

Width	5.71 in / 145.03 mm
Depth	2.13 in / 54.10 mm
Height	4.09 in / 103.89 mm



# DTS+ MOBILE

## PRODUCT OVERVIEW



## HIGHLIGHTS

---

### Portable Spot-free water system.

- Provides spot-free water from your municipal or dockside source
- Spot-free rinse eliminates chamoising, saves time and reduces maintenance
- 100% sealed electrical plug and large wheels for easy mobility
- Filter and membrane-saving bypass mode

## SPECIFICATIONS

---

### ELECTRICAL REQUIREMENTS

**VAC 120 / 208-240**

**Phase 1**

**HZ 50 / 60**

# DTS+ MOBILE

## PARTS & DIMENSIONS

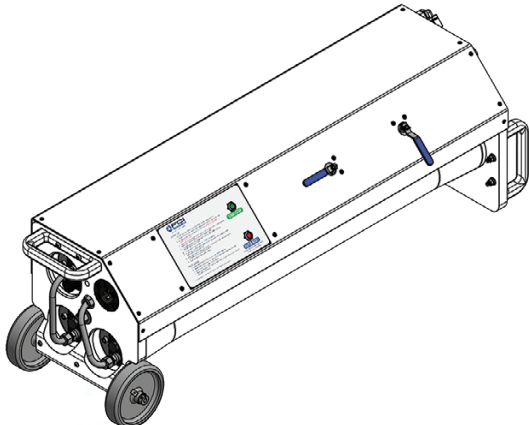

### DTS+ UNIT

Width	51.30 in / 1303.02 mm
Depth	14.75 in / 374.65 mm
Height	15.38 in / 390.65 mm

### AVAILABLE PRODUCT OPTIONS

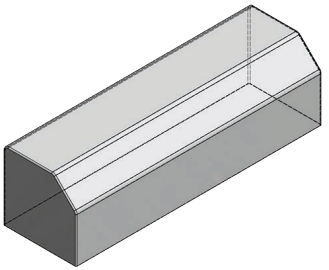

### COVER

Width	54.00 in / 1371.60 mm
Depth	16.00 in / 406.40 mm
Height	15.25 in / 387.35 mm

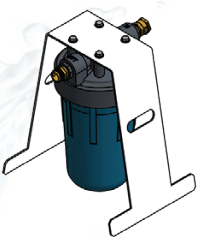

### CLEANING KIT

Width	10.07 in / 255.78 mm
Depth	12.28 in / 311.91 mm
Height	14.08 in / 357.63 mm

# COMPARE DTS+ WATERMAKERS



MODEL	DTS+ MOBILE	DTS+	DTS+ AUTO	DTS+ SOLO
<b>FEATURES</b>				
Purifies dock water for drinking and cooking with no equipment on the dock	☑	☑	☑	☑
Spot-Free Rinse	☑	☑	☑	☑
Includes GAC Sediment Filter	☑	☑	☑	☑
90% Recover Rate	☑			
70% Recover Rate		☑	☑	
80% Recover Rate				☑
Removes up to 99% total dissolved solids (TDS)	☑	☑	☑	☑
Filter-saving bypass mode	☑			
Intelligent control system with service indicator	☑			
On/Off touch switch	☑			
100% sealed electrical plug	☑			
Utilizes Existing Pump and Control System		☑	☑	
Fully Automatic			☑	
Available in Single or Dual-Feed				☑
On-Board Standalone Unit				☑
<b>OPTIONS</b>				
DTS+ Mobile Cover	☑			
DTS+ Mobile Prefilter	☑			
DTS+ Solo Remote				☑
Compatible with MaxQ+ Series		☑	☑	
Compatible with Aquamiser+		☑		
Cleaning Kit	☑	☑	☑	☑

# COMPARE DTS+ WATERMAKERS



**DTS+ MOBILE**



**DTS+**



**DTS+ AUTO**



**DTS+ SOLO**

MODEL	DTS+ MOBILE	DTS+	DTS+ AUTO	DTS+ SOLO
<b>DIMENSIONS</b>				
Width	51.30 in / 1303.02 mm	12.00 in / 304.8 mm	22.00 in / 558.80 mm	-
Depth	14.75 in / 374.65 mm	6.32 in / 160.53 mm	8.58 in / 217.93 mm	-
Height	15.38 in / 390.65 mm	12.84 in / 326.14 mm	12.72 in / 323.09 mm	-
Pressure Vessel Width	-	47.40 in / 1203.96 mm	47.40 in / 1203.96 mm	-
Pressure Vessel Depth	-	4.39 in / 111.51 mm	4.39 in / 111.51 mm	-
Pressure Vessel Height	-	7.00 in / 177.80 mm	7.00 in / 177.80 mm	-
GAC Filter Depth	12.31 in / 312.67 mm	12.31 in / 312.67 mm	12.31 in / 312.67 mm	22.24 in / 564.90 mm
GAC Filter Width	8.09 in / 205.49 mm	8.09 in / 205.49 mm	8.09 in / 205.49 mm	7.13 in / 181.10 mm
GAC Filter Height	13.76 in / 349.50 mm	13.76 in / 349.50 mm	13.76 in / 349.50 mm	13.93 in / 353.82 mm
Wall Mount Width	-	-	-	23.42 in / 594.87 mm
Wall Mount Depth	-	-	-	13.96 in / 354.58 mm
Wall Mount Height	-	-	-	26.59 in / 675.39 mm
Deck Mount Width	-	-	-	23.42 in / 594.87 mm
Deck Mount Depth	-	-	-	14.44 in / 366.78 mm
Deck Mount Height	-	-	-	30.00 in / 762.00 mm

**ALL DTS+ WATERMAKERS INCLUDE:**

- Purified dock water for drinking and cooking with no equipment on the dock
- Spot-Free Rinse
- GAC Sediment Filter

# ACCESSORIES



## ULTRA VIOLET STERILIZERS

FCI stainless steel units provide 99.8% sterilization of bacteria and micro-organisms in water. Available in a variety of flow rates.



## MEDIA FILTER

FCI Watermakers manufactures Media Filter systems in a multitude of sizes for particulate and iron removal.



## REPLACEMENT PARTS

FCI carries a complete line of replacement parts: membranes, filters, hoses, fittings, spanners, o-rings and more.



## REMOTE DISPLAY

The intuitive interface includes one-touch Startup and Fresh Water Flushes with easy access to system customization and automated features.



## AQ3 REMOTE

Enhance the Aqualite and Aquamiser+ Series controls by adding a remote display.



# CLEAN WATER TO THE WORLD

## FCI WATERMAKERS WORLDWIDE DISTRIBUTION

Users enjoy a worldwide service network, as well as customer service and technical support directly from our manufacturing facility.

**You can find FCI Watermakers in these global locations and more:**

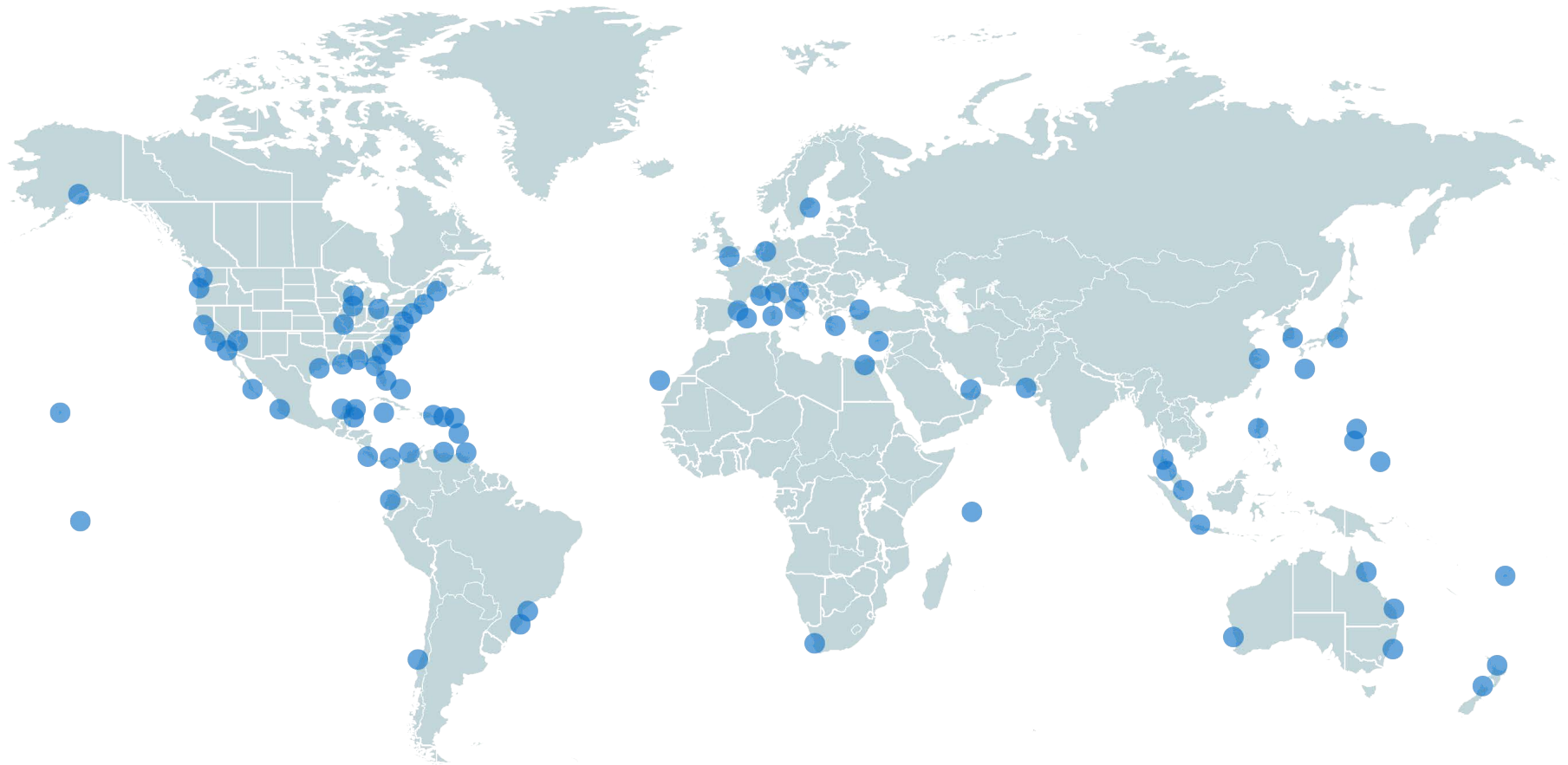

# CONTACT US



## ADDRESS

3782 W 2340 S “E” West Valley, UT 84120



## HOURS

M–F 8AM to 5PM MT



## EMAIL

[info@fcewatermakers.com](mailto:info@fcewatermakers.com)



## PHONE

801.906.8840 Within the USA

800.850.0123 Toll Free









THE DIFFERENCE IS CLEAR

801.906.8840  
[www.fcewatermakers.com](http://www.fcewatermakers.com)